

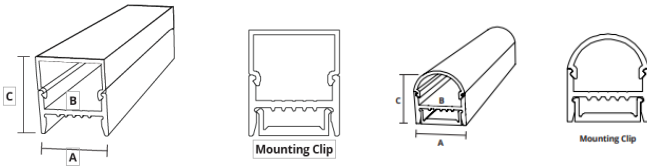

PHYSICAL

Material	Anodized Aluminum
Lens Cover	Polycarbonate
Width	A: 0.77" (19.50mm)
Inner Width	B: 0.65" (16.50mm)
Height	C: 0.86" (21.80mm)
Length	39" or 78"

DIMENSIONS



ACCESSORIES

	PART#
Plastic End Cap	AMC-2020-S-EC-SQ
Plastic End Cap w/hole	AMC-2020-S-ECL-SQ
Plastic End Cap	AMC-2020-S-EC-RO
Plastic End Cap w/hole	AMC-2020-S-ECL-RO
Mounting Clip	AMC-2020-S-MC

ACCESSORIES

	PART#
Opal Lens for Square	AMC-2020-S-SQ-O
Opal Lens for Round	AMC-2020-S-RO-O

FINISH

Satin Aluminum

SPECIFICATION

SERIES	DIMENSIONS	CHANNEL TYPE	LENGTH	LENS TYPE	FINISH
AMC = Channel	2020= H 19.00mm x 22.00mm	S=Surface Mount Channel	1M = 39" 2M = 78" XX" = Custom	O= Opal Lens *SQ=Square *RO=Round	SL = Satin Aluminum



ACCESSORIES
AMC-2020-S-EC-RO

Plastic End Cap Round

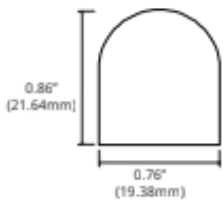
AMC-2020-S-ECL-RO

Plastic End Cap w/Hole Round

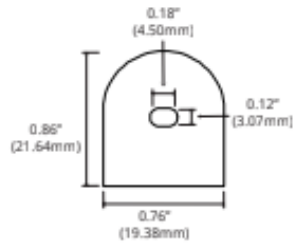
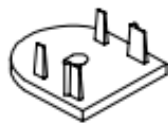
AMC-2020-S-MC

Mounting Clip

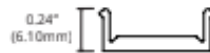
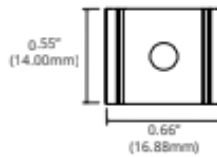
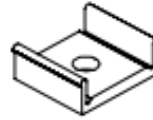
AMC-2020-S-O-RO

Opal Lens-Round

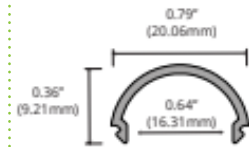
AMC-2020-S EC-SQ

Plastic End Cap Square

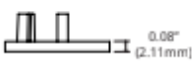
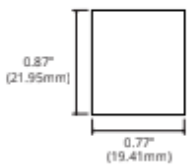
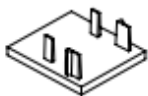
AMC-2020-S-ECL-SQ

Plastic End Cap Square w/hole

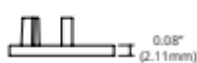
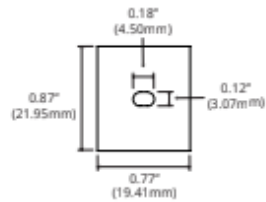
AMC-2020-S-O-SQ

Opal Lens-Square

